



SPORT LINE

44 39 35 32 29



BAVARIA
MOTORBOATS



HIGH QUALITY

BAVARIA Yachts has one of the highest quality and safety standards in the entire yacht construction industry, together with state of the art style and design. One reason for this is our close collaboration with the leading construction and design companies in the world. Together, we develop high-performance models which easily surpass all CE requirements. Additionally, our yachts, as well as our production facility, are regularly inspected and certified by Germanischer Lloyd.

HIGH CLASS

BAVARIA is one of the most successful yacht builders in the world. We painstakingly follow customer requests in developing trendsetting sail and motor yachts which combine performance, comfort and outstanding value. Our entire work is based on many years of experience, the professional excellence of our staff and one of the most modern production facilities in the world. With our global distribution network we ensure on-site delivery and service.



SPORT LINE

Sport and style

A luxurious life on the water exerts a very special fascination. This becomes palpable aboard the BAVARIA SPORT line – whether in a cosy bay or a sprint on the high seas. The SPORT line represents a stunningly successful combination of timeless design, supreme comfort and sportive performance. A modern yacht line for all those who have subscribed to the maritime lifestyle.

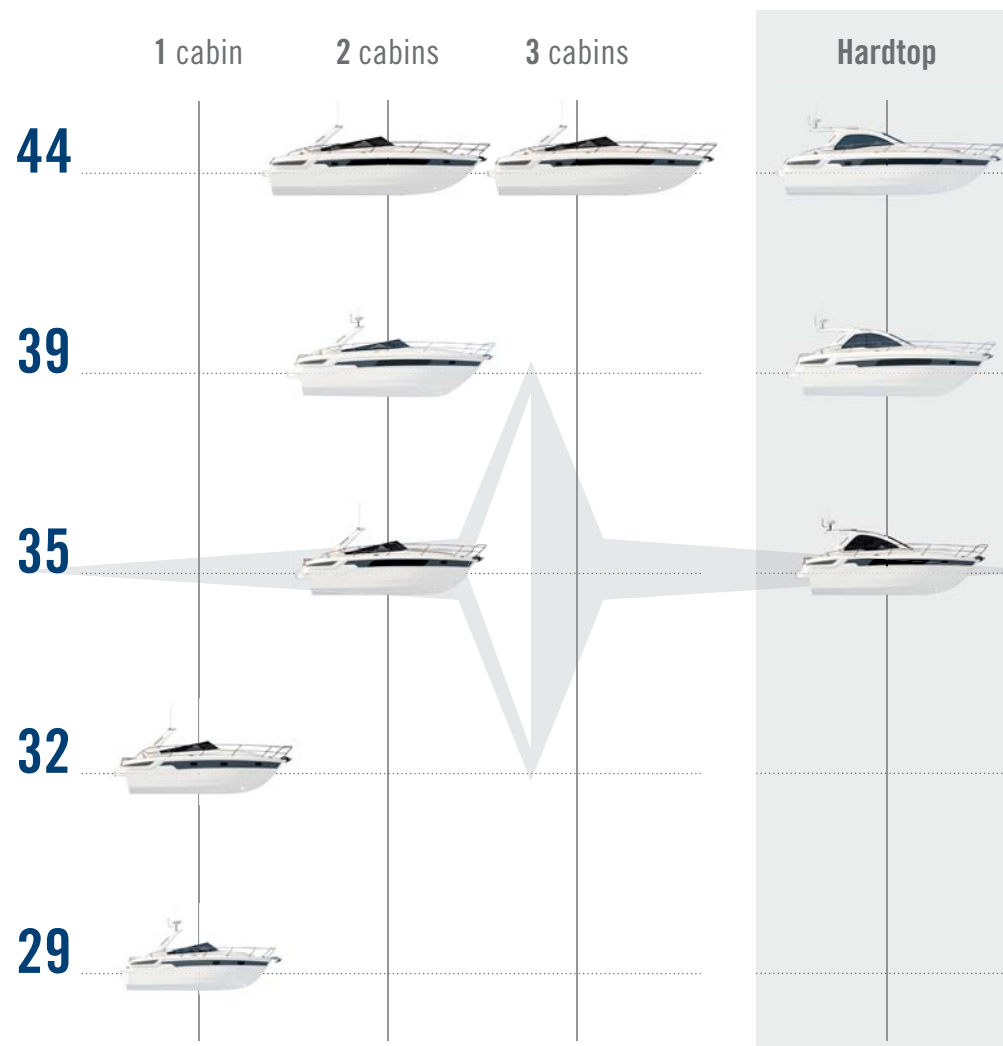

44



SPORT 44

The new dimension

Head for the sun and the open sea aboard the sporting yet luxurious SPORT 44. The abundant deck has been designed to comfortably accommodate a co-pilot seat bench, lounge, bench seat around the cockpit table and a generous reclining area at the stern. Plenty of room to enjoy the finer things in life.



44 | Pure luxury



As one of just a few 44-foot yachts, the SPORT 44 is available with three cabins. The headroom of up to 2.10 m and numerous deck hatches and hull windows create a welcoming ambiance. An optional air-conditioning system is also available for the cabins.





44 | Technical data





Deck layout

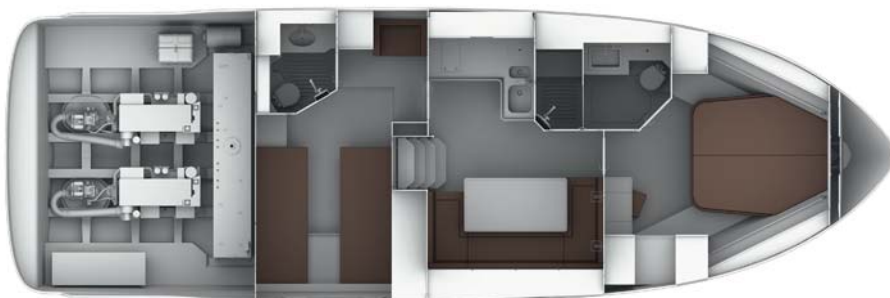

2-cabin version

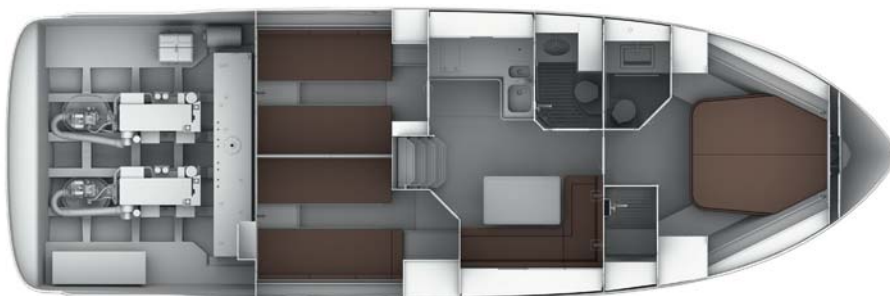

3-cabin version



Length overall	13.83 m
Length hull	13.22 m
Beam overall	4.41 m
Height above waterline	3.35 m
Draught, drive raised	0.75 m
Draught, drive lowered	1.10 m
Light weight displacement	11,750 kg
Fuel tank	1,500 l
Water tank	410 l
Cabins	2/3
Berths	4/6
Height in cabin	2.10 m
Passengers, max. (CE B)	12
Motorisation	MerCruiser petrol engines
	2 x 8.2 MAG HO DTS Brav. III XR (2 x 316 kW/430 PS)

All data is subject to change without notice and given without warranty.

44 | Hardtop





Deck layout

The hardtop version of the SPORT 44 is stunning. The attractively shaped hardtop is in perfect harmony with the yacht design. The optional electric glass sunroof opens at the push of a button. Sun, wind and the sea – a unique experience aboard the SPORT 44 HT.

Length overall	13.83 m
Length hull	13.22 m
Beam overall	4.41 m
Height above waterline	3.33 m
Draught, drive raised	0.75 m
Draught, drive lowered	1.10 m
Light weight displacement	11,950 kg
Fuel tank	1,500 l

Water tank	410 l
Cabins	2/3
Berths	4/6
Height in cabin	2.10 m
Passengers, max. (CE B)	12
Motorisation	MerCruiser petrol engines
	2 x 8.2 MAG HO DTS Brav. III XR (2 x 316 kW/430 PS)

All data is subject to change without notice and given without warranty.



39



SPORT 39

Wellness on the water

Dynamic, powerful proportions, plus the utmost in space and comfort, the SPORT 39 offers everything you want from a modern motor yacht. The cockpit has a clear layout and an ergonomic design. The co-pilot can choose between relaxing on the lounge or braving the wind in the co-pilot's seat.



39 | True delight



A lounge area, saloon table and fully equipped pantry make cooking at sea a genuine pleasure. The functional wet room is spacious and boasts excellent workmanship. The owner's cabin features a large double bed.

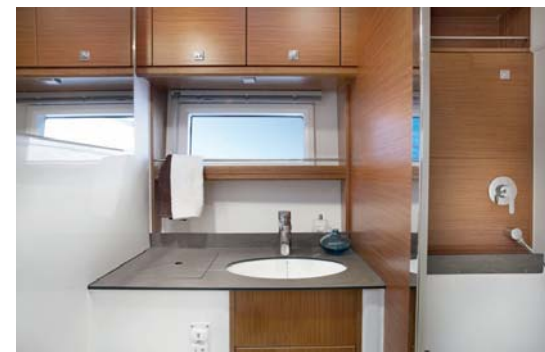
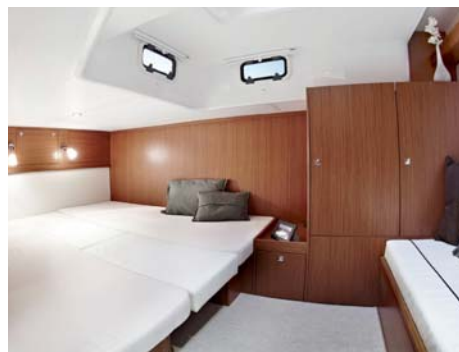



39 | Technical data





Deck layout



2-cabin version

Length overall	11.80 m
Length hull	11.65 m
Beam overall	3.99 m
Height above waterline	3.33 m
Draught, drive raised	0.70 m
Draught, drive lowered	1.05 m
Light weight displacement	8,200 kg
Fuel tank	720 l

Water tank	250 l
Cabins	2
Berths	4
Height in cabin	2.10 m
Passengers, max. (CE B)	12
Motorisation	MerCruiser petrol engines 2 x 377 MAG DTS Brav. III (2 x 235 kW/320 PS)

All data is subject to change without notice and given without warranty.



39 | Hardtop

39 HT





Deck layout

The SPORT 39 is also outstanding as a hardtop version. Thanks to the large panoramic window, the pilot has excellent all-round visibility. The optional electric glass sunroof opens incrementally as needed.

Length overall	11.80 m
Length hull	11.65 m
Beam overall	3.99 m
Height above waterline	3.23 m
Draught, drive raised	0.70 m
Draught, drive lowered	1.05 m
Light weight displacement	8,500 kg
Fuel tank	720 l

Water tank	250 l
Cabins	2
Berths	4
Height in cabin	2.10 m
Passengers, max. (CE B)	12
Motorisation	MerCruiser petrol engines 2 x 377 MAG DTS Brav. III (2 x 235 kW/320 PS)

All data is subject to change without notice and given without warranty.





35

SPORT 35



Right on course in confident style

Whether you are in a small swimming bay or an exclusive yacht harbour, you are guaranteed to impress with the SPORT 35. Families will feel right at home here due to the carefully planned layout and high safety standards. Children can get in and out of the water safely via the large swimming platform.

35 | Love of detail



Below deck, the SPORT 35 offers a bright and friendly setting, with the wide hull windows letting in plenty of light. Generous storage spaces and many intelligent detail solutions turn any stay on board into an unforgettable experience.



35 | Technical data





Deck layout

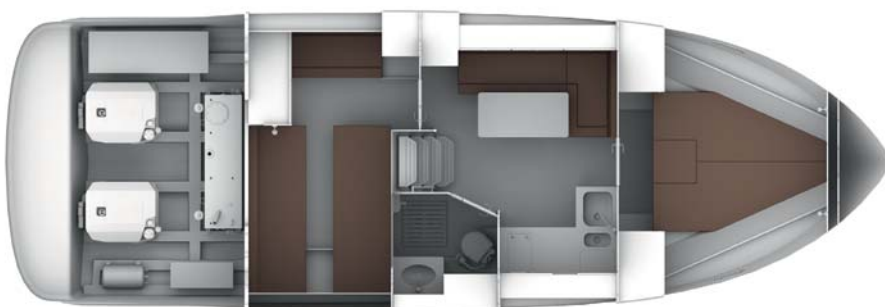

2-cabin version



Length overall	10.80 m
Length hull	10.28 m
Beam overall	3.59 m
Height above waterline	3.23 m
Draught, drive raised	0.70 m
Draught, drive lowered	1.15 m
Light weight displacement	6,200 kg
Fuel tank	520 l

Water tank	150 l
Cabins	2
Berths	4
Height in cabin	1.90 m
Passengers, max. (CE B)	8
Motorisation	MerCruiser petrol engines 2 x 5.0 MPI DTS Brav. III (2 x 191 kW/260 PS)

All data is subject to change without notice and given without warranty.

35 | Hardtop





Deck layout

The hardtop SPORT 35 version looks especially elegant. Due to large side windows and a wide wind-shield, the pilot always has unimpaired visibility while the guests onboard can still enjoy the view even on stormy days.

Length overall	10.80 m
Length hull	10.28 m
Beam overall	3.59 m
Height above waterline	3.03 m
Draught, drive raised	0.70 m
Draught, drive lowered	1.15 m
Light weight displacement	6,300 kg
Fuel tank	520 l

Water tank	150 l
Cabins	2
Berths	4
Height in cabin	1.90 m
Passengers, max. (CE B)	8
Motorisation	MerCruiser petrol engines 2 x 5.0 MPI DTS Brav. III (2 x 191 kW/260 PS)

All data is subject to change without notice and given without warranty.



32



SPORT 32

Sportive recreation

Fans of sporty motor yachts will rave about the SPORT 32. Whether a breakneck sprint over the waves or a hard-taken turn, the SPORT 32 masters these and other challenges with perfect ease. Thanks to its comfortable fittings and thoughtfully planned cabin layout, the SPORT 32 offers plenty of space to relax.



32 | Simply fantastic



The layout of the SPORT 32 is impressive: with just a few adjustments, the suite of seats in the forward cabin can be transformed into a comfortable double bed and the two twin beds in the owner's cabin can be converted effortlessly into a double bed. This innovative design will comfortably sleep four people.



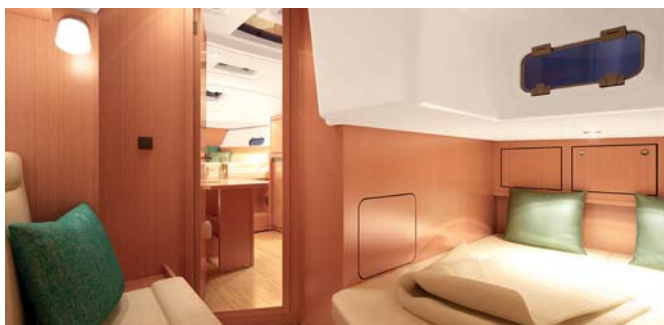

32 | Technical data





Deck layout



1-cabin version

Length overall	10.06 m
Length hull	9.61 m
Beam overall	3.31 m
Height above waterline	3.08 m
Draught, drive raised	0.73 m
Draught, drive lowered	1.21 m
Light weight displacement	5,470 kg
Fuel tank	520 l

Water tank	150 l
Cabins	1
Berths	4
Height in cabin	1.90 m
Passengers, max. (CE B)	8
Motorisation	MerCruiser petrol engines 2 x 5.0 MPI DTS Brav. III (2 x 191 kW/260 PS)

All data is subject to change without notice and given without warranty.



29



SPORT 29



In great shape

Sporty, dynamic and with powerful proportions, the SPORT 29 guarantees fun on the water. Powerboaters who prefer a thrilling ride will get their money's worth. The deck is spacious and comfortable with numerous lounges and seats. The SPORT 29 is equally impressive below deck.

29 | Bright joy



With its suite of seats and large table, the saloon in the forward cabin invites you to relax. The seats can be converted easily into another berth if needed. An exquisite double bed in the stern provides a comfortable owner's section. The perfectly integrated wet room has plenty of stowage space and numerous storage areas.





29 | Technical data





Deck layout

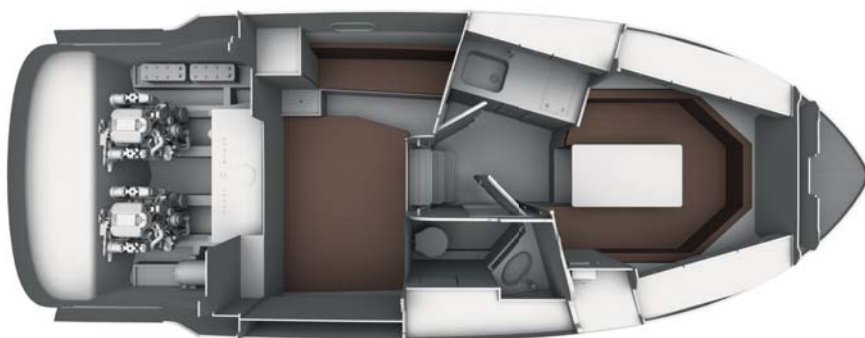

1-cabin version

Length overall	8.95 m
Length hull	8.50 m
Beam overall	2.99 m
Height above waterline	2.80 m
Draught, drive raised	0.50 m
Draught, drive lowered	0.90 m
Light weight displacement	4,000 kg
Fuel tank	520 l

Water tank	120 l
Cabins	1
Berths	4
Height in cabin	1.85 m
Passengers, max. (CE B)	6
Motorisation	MerCruiser petrol engines 1 x 377 MAG DTS Brav. III (1 x 235 kW/320 PS)

All data is subject to change without notice and given without warranty.

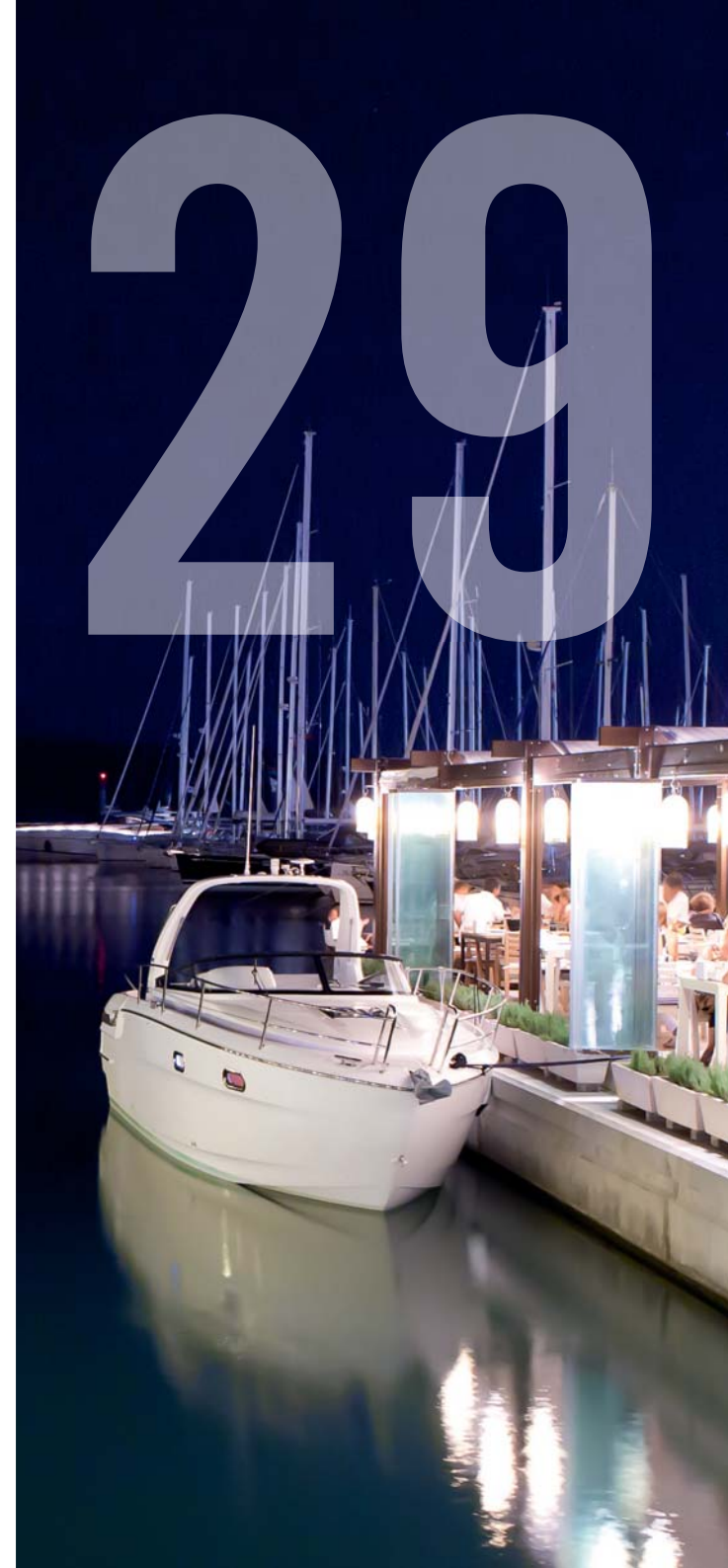



FEATURES



Ergonomic helm stand with clear layout, 3-spoke sport wheel, steering compass and joystick for the Volvo Penta IPS

First-rate equipment

The workmanship of the SPORT line and its innovative details are impressive. The stylishly functional cockpit and the generous swimming platforms are without equal.

Features



Beverage holder



Large hydraulic swimming platform with integrated swimming ladder and comfortable sun lounger with stainless-steel handrail



Pulpit with passage and easily accessible **anchor locker** with **freshwater filler neck**



Fuel filler neck underneath teak grating



Wide and safe access to the forward cabin with **LED ambient lighting**



INTERIOR











Inner values

The modern design and intelligent layout of the SPORT line continue below deck. The interior can be precisely matched to your personal preferences, with three veneers and four types of floor materials to choose from.

Twelve upholstery covers including exclusive fabrics and elegant leather are available to create a customised setting below deck.

Information about the available combinations can be obtained from your BAVARIA shop.

	Veneer	Flooring
Standard	 <p>Mahogany</p>	 <p>Oak nature</p>  <p>Chestnut (option)</p>  <p>Ocean Line (option)</p>
Option	 <p>Oak</p>  <p>Teak</p>	 <p>Walnut nature</p>  <p>Ocean Line (option)</p>

Upholstery

Fabric



Leather (option)



Real Leather (option for SPORT 44)



EXTERIOR



Looking perfect

Distinguish your BAVARIA motor yacht with a customised look. Two different flooring materials, eight upholstery styles and six colours for the exterior deck areas give you numerous combinations.



Flooring



Teak or DURA-DECK

Hull colour



White, Stripe Dark Grey



Grey, Stripe White (option)



Grey, Stripe Dark Grey (option)

Hood



Stone



Fox



Navy



Sand



Black



Dove

Synthetic leather



Snow



Sand



Stone

Suntex (option)



Dove

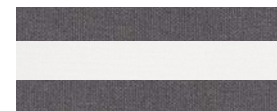

Meteor



Champagner



Yet



Wine

Partners

We apply exacting standards to the production and quality of our yachts. Equally, these standards must also be met by the equipment, furnishings and accessories we offer. We meet our stringent requirements by collaborating with renowned business partners, all of which are market leaders in their respective fields.



since 1927





BAVARIA Yachtbau GmbH · Bavariastrasse 1 · 97232 Giebelstadt · Germany · Tel. +49 9334 942-0 · Fax +49 9334 942-1160
www.bavaria-yachtbau.com · info@bavaria-yachtbau.com

Some of the yachts shown here are equipped with optional extras which are available at an additional cost. Some details are based on design drawings and the final execution may differ.
This catalogue is not part of a contract. All descriptions, photos, etc. are for illustration purposes only.

